

PROPOSED BOUNDARY MAP AND FUTURE ANNEXATION AREA OF
CITY OF LANCASTER COMMUNITY FACILITIES DISTRICT NO. 2021-1
(PUBLIC SERVICES)

SHEET 1 OF 2

COUNTY OF LOS ANGELES
STATE OF CALIFORNIA



FILED IN THE OFFICE OF THE CITY CLERK THIS _____
DAY OF _____, 202__.

I HEREBY CERTIFY THAT THE WITHIN MAP SHOWING
PROPOSED BOUNDARY MAP AND FUTURE
ANNEXATION AREA OF COMMUNITY FACILITIES
DISTRICT NO. 2021-1 (PUBLIC SERVICES), CITY OF
LANCASTER, COUNTY OF LOS ANGELES, STATE OF
CALIFORNIA, WAS APPROVED BY THE CITY
COUNCIL OF THE CITY OF LANCASTER AT A REGULAR
MEETING THEREOF, HELD ON THE _____ DAY OF
_____, 202__, BY ITS RESOLUTION NO.
_____.

CITY CLERK
CITY OF LANCASTER

FILED THIS _____ DAY OF _____, 202__, AT THE
HOUR OF _____ O'CLOCK __.M. IN THE BOOK _____
OF MAPS OF ASSESSMENT AND COMMUNITY FACILITIES
DISTRICTS, PAGE(S) _____ AND AS INSTRUMENT NO.
_____ IN THE OFFICE OF THE COUNTY
RECORDER IN THE COUNTY OF LOS ANGELES, STATE OF
CALIFORNIA.

BY DEPUTY
COUNTY RECORDER
COUNTY OF LOS ANGELES
STATE OF CALIFORNIA

THE LINES AND DIMENSIONS OF EACH LOT OR PARCEL
SHOWN ON THIS DIAGRAM SHALL BE THOSE LINES AND
DIMENSIONS AS SHOWN ON THE LOS ANGELES COUNTY
ASSESSOR'S MAPS FOR THOSE PARCELS LISTED.

THE LOS ANGELES COUNTY ASSESSOR'S MAPS SHALL
GOVERN FOR ALL DETAILS CONCERNING THE LINES AND
DIMENSIONS OF SUCH LOTS OR PARCELS.



- PROPOSED DISTRICT BOUNDARY
- FUTURE ANNEXATION AREA
- MAP REFERENCE NUMBER

MAP REFERENCE NUMBER	ASSESSOR'S PARCEL NUMBER
1	3153-005-024
2	3153-005-025
3	3153-005-078
4	3153-005-088



PROPOSED BOUNDARY MAP AND FUTURE ANNEXATION AREA OF
CITY OF LANCASTER COMMUNITY FACILITIES DISTRICT NO. 2021-1
(PUBLIC SERVICES)

SHEET 2 OF 2

COUNTY OF LOS ANGELES
STATE OF CALIFORNIA

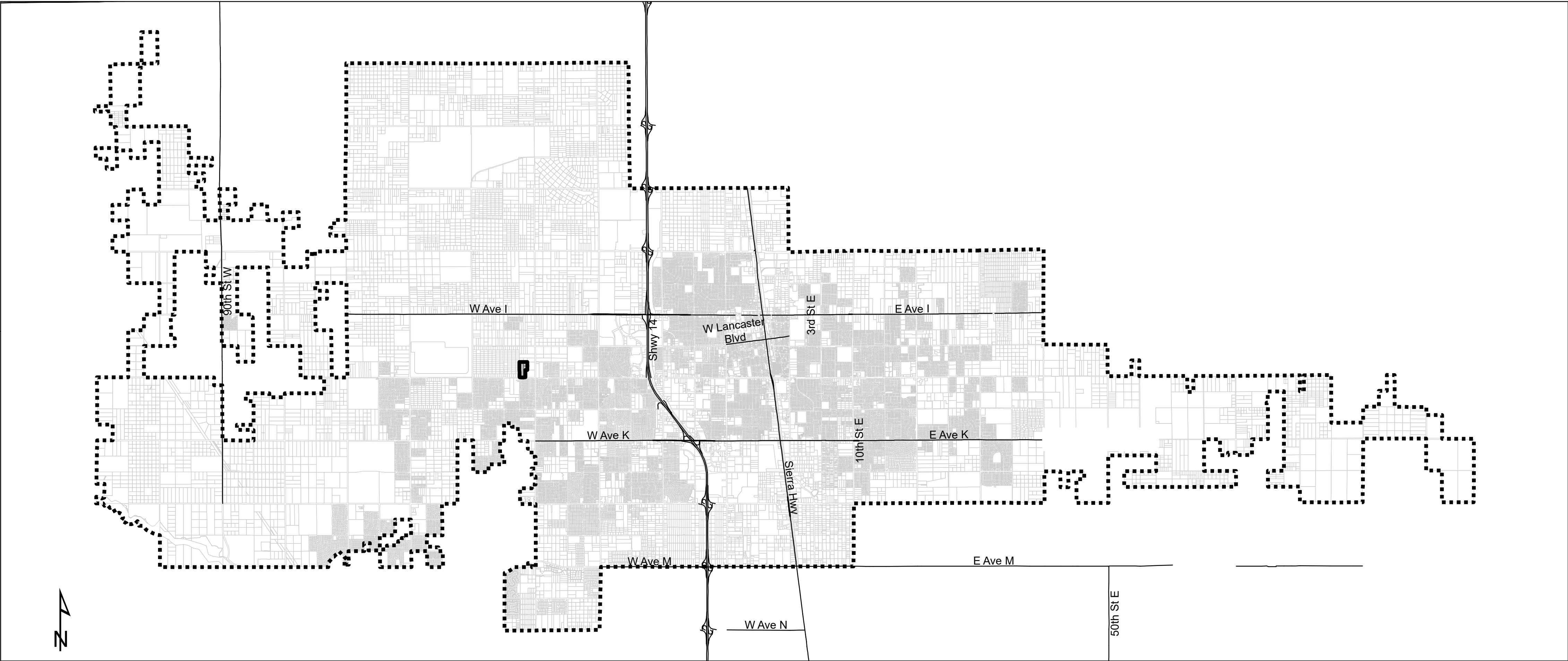

LEGEND

- PROPOSED DISTRICT BOUNDARY
- FUTURE ANNEXATION AREA