

| GENERAL NOTES |  |
|---------------|--|
| 1.            | WRITTEN DIMENSIONS SHALL TAKE PRECEDENCE OVER SCALE. ALL DIMENSIONS SHALL BE TO THE FACE OF WALL, OR TO THE FACE OF CONCRETE, OR TO THE FACE OF MASONRY, UNLESS OTHERWISE NOTED OR DETAILED.   |
| 2.            | THE CONTRACTOR SHALL FAMILIARIZE HIMSELF/HERSELF WITH THE JOBSITE CONDITIONS, ADDRESS AND REPORT ANY AND ALL DISCREPANCIES TO THE ARCHITECT IN WRITING. THESE CONDITIONS SHALL BE RESOLVED PRIOR TO THE START OF ANY WORK OR DEMOLITION. WRITTEN CLARIFICATION(S) FROM THE ARCHITECT WILL BE FORWARDED TO THIS CONTRACTOR FOR FURTHER REVIEW AND ACTION. |
| 3.            | REFER TO CIVIL DRAWINGS AND PRECISE GRADING PLANS FOR ELEVATION CALLOUTS, DRAINAGE, ETC.   |
| 4.            | HEAVY INDUSTRIAL SET BACK REQUIREMENTS PER 17.16.130.B.2   |
| 5.            | THE MAXIMUM FLOOR AREA RATIO IS 0.5.   |
| 6.            | ALL PROPOSED PROJECT SIGNS ARE SHOWN ON THE SITE PLAN. NOTED ONSITE PLAN.  |

## FIRE DEPARTMENT NOTES

PUBLIC FIRE HYDRANT REQUIREMENTS: INSTALL 5 PUBLIC 6"x4"x2 1/2" FIRE HYDRANTS CONFORMING TO AMERICAN WATERWORKS ASSOCIATION STANDARD C503

PUBLIC FIRE FLOW REQUIREMENTS: 4,000 GPM @ 20PSI FOR 4 HOURS. FIRE SPRINKLERS REQUIRED. FIRE FLOW SUBJECT TO REDUCTION

PRIVATE FIRE HYDRANT REQUIREMENTS: INSTALL 4 6"x4"x2 1/2" FIRE HYDRANTS CONFORMING TO AMERICAN WATERWORKS ASSOCIATION STANDARD C503

PRIVATE FIRE FLOW REQUIREMENTS: 2,500 GPM @ 20PSI FOR 2 HOURS.

THE FIRE APPARATUS ACCESS ROAD SHALL PROVIDE A MINIMUM UNOBSTRUCTED WIDTH OF 28 FEET, EXCLUSIVE OF SHOULDERS AND AN UNOBSTRUCTED VERTICAL CLEARANCE "CLEAR TO SKY" DUE TO THE BUILDING HEIGHT EXCEEDING A DISTANCE OF 30 FEET BETWEEN THE FIRE APPARATUS ACCESS ROAD AND THE HIGHEST ROOF SURFACE. THE FIRE APPARATUS ACCESS ROAD SHALL BE LOCATED BETWEEN 10 FEET AND 30 FEET FROM THE BUILDING AND SHALL BE POSITIONED PARALLEL TO ONE ENTIRE SIDE OF THE BUILDING. FIRE CODE 503.2.1.2.2 & 503.2.1.2.2.1

PROVIDE A MINIMUM 32-FOOT CENTERLINE TURNING RADIUS FOR THE FIRE APPARATUS ACCESS ROAD. INDICATE THE CENTERLINE, INSIDE AND OUTSIDE TURNING RADII FOR EACH CHANGE IN DIRECTION, ON THE PLAN. FIRE CODE 503.2.4

CLEARLY IDENTIFY THE FIREFIGHTER WALKWAY ACCESS ROUTES LEADING FROM THE FIRE DEPARTMENT ACCESS ROAD TO ALL REQUIRED OPENINGS IN THE BUILDING'S EXTERIOR WALLS FOR FIREFIGHTING AND RESCUE PURPOSES ON THE PLAN AND INDICATE THE REQUIRED WIDTH OF 5 FEET. FIRE CODE 504.1

PROVIDED AN APPROVED FIRE DEPARTMENT TURNAROUND DUE TO THE DEAD-END FIRE APPARATUS ACCESS ROAD IN EXCESS OF 150 FEET IN LENGTH, THE TURNAROUND SHALL BE ORIENTED ON THE ACCESS ROADWAY IN THE PROPER DIRECTION OF TRAVEL. FIRE CODE 503.2.5.

GATES USED TO CONTROL VEHICULAR ACCESS SHALL BE IN COMPLIANCE SET FORTH IN FIRE CODE SECTIONS 503.5 & 503.6

| PROJECT INFORMATION |  |   |   |
|---------------------|--|---|---|
| PROJECT:            | HYDROGEN GENERATION PLANT  | SETBACKS:   | PER SECTION 17.16.130.B.2   |
| BUILDING LOCATION:  | AVENUE M & 5TH STREET EAST   | FRONT   | = 10 FEET   |
| APN:                | APN 3126-017-028, 039, 040   | SIDE YARD   | = 0 FEET  |
| SCOPE OF WORKS:     | SITE DEVELOPMENT, NEW LANDSCAPING, GRADING, PARKING LOT, HYDROGEN GENERATION EQUIPMENT AND STRUCTURES. | REAR YARD   | = 10 FEET (AVENUE M)  |
| USE:                | HYDROGEN GENERATION PLANT  | UTILITIES   | = MUST BE UNDERGROUND   |
| ZONING:             | HEAVY INDUSTRIAL   | LANDSCAPING:  | = 31,486 SF PROVIDED  |
| CONSTRUCTION TYPE:  | IIIB   | REFUSE/RECYCLING STRG.:   | 165 SF MINIMUM TRASH ENCLOSURE  |
| OCCUPANCY:          | B ADMIN BUILDING, S-1 WAREHOUSE BUILDINGS.   | PARKING:  |   |
| SPRINKLER BUILDING: | YES  | REQUIRED  | = OFFICE 9,037/250 = 36<br>WAREHOUSE 5 SPACES FOR 25,000 SF + 1 PER ADD. 5,000 SF = 8 |
| FIRE ALARM:         | YES  | REQUIRED  | = 44  |
| NUMBER OF STORIES:  | 1 STORY (3 STORIES / 35' HEIGHT MAX)<br>ADMIN BUILDING 2 STORY   | PROVIDED  | = 44  |
| LOT AREA:           | GROSS 12.55 ACRES NET 12.36 ACRES  | EV PARKING:   | = 4   |
|                     |  | BICYCLE   | = 4   |
|                     |  | ADA PROVIDED  | = 2   |
|                     |  | BIOGASS STORAGE BUILDING NO OCCUPANCY   | = 11,000 SF   |
|                     |  | WATER TREATMENT BUILDING  | = 18,585 SF   |
|                     |  | THERE WILL BE A TOTAL OF 25 EMPLOYEES ON SITE PER SHIFT. THE TOTAL REQUIRED AND PROVIDED PARKING SPACES IS SUFFICIENT FOR THE PROPOSED DEVELOPMENT. |   |

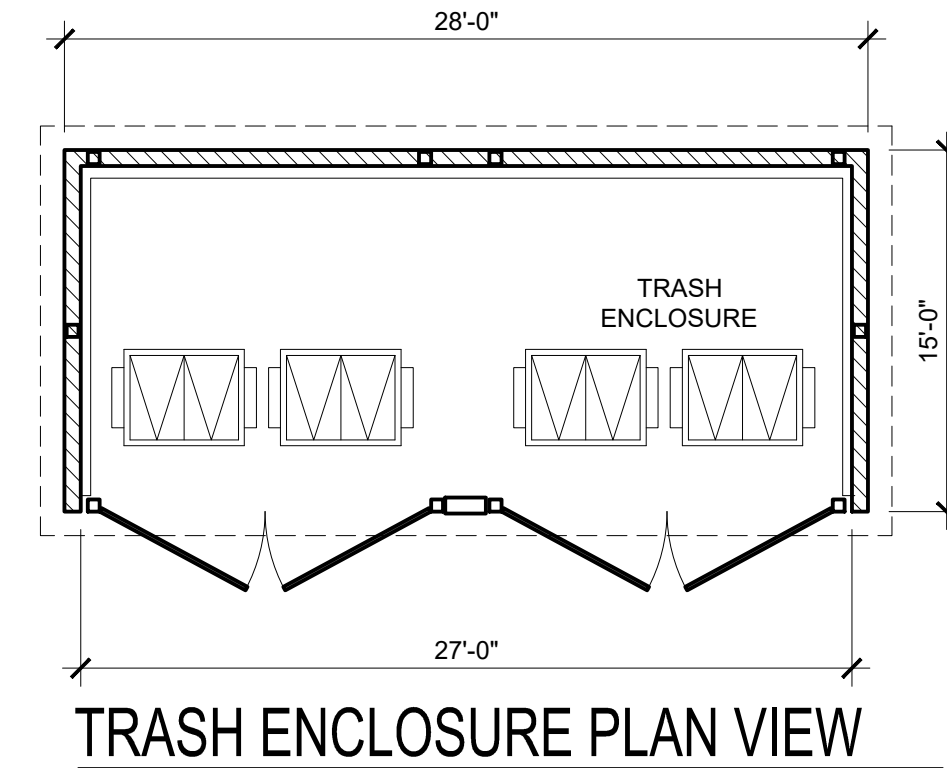
[illegible]

| WBS       | UNIT   |
|-----------|--|
| 110       | AIR SEPARATION UNIT (ASU)  |
| 210       | BIOMASS,BIOCHAR AND LIMESTONE UNLOADING AND STORAGE                      |
| 310       | PLASMA GASIFICATION AND BIOMASS/BIOCHAR/LIMSTONE PREPARATION AND FEEDING |
| 250       | SLAG HANDLING AND STORAGE  |
| 310 / 320 | SYNGAS QUENCH/HEAT RECOVERY STEAM GENERATOR (HRSG)                       |
| 330 / 340 | SYNGAS SCRUBBING (VENTURI AND CHLORIDE SCRUBBER)                         |
| 410       | SYNGAS COMPRESSION   |
| 420       | WATER-GAS SHOR SHIFT AND SYNGAS/COOLING                                  |
| 430       | H2S REMOVAL (H2S SCAVENGER)  |
| 510       | HYDROGEN PSA,CO2 REMOVAL AND LIQUEFACTION (CRYOCAP)                      |
| 520       | HYDROGEN COMPRESSION AND STORAGE   |
| 530       | PROCESS WASTE WATER TREATMENT  |
| 540       | POWER GENERATION   |
| 550       | HYDROGEN PRODUCT LOADING   |
| 910       | RAW / TREATED WATER SYSTEM   |
| 911       | DEMIN WATER SYSTEM   |
| 912       | STEAM / CONDENSATE SYSTEM  |
| 913       | BOILER FEED WATER SYSTEM   |
| 914       | SERVICE / POTABLE WATER SYSTEM   |
| 915       | COOLING WATER SYSTEM   |
| 916       | FIRE WATER / FIRE PROTECTION SYSTEM                                      |
| 917       | CHILLED WATER SYSTEM   |
| 920       | STORM / OILY WATER SEWER   |
| 921       | WASTE WATER TREATMENT  |
| 931       | EMERGENCY GENERATOR  |
| 940       | FLARE SYSTEM   |
| 950       | PLANT / INSTRUMENT AIR SYSTEM/NITROGEN SYSTEM                            |
| 951       | NATURAL GAS / FUEL GAS SYSTEM  |
| 952       | OSBL PIPERACKS   |
| 960       | BUILDINGS INCLUDING ADMIN/WAREHOUSE AND LABS.                            |
| 970       | DISTRIBUTED CONTROL SYSTEMS  |
| 980       | POWER DISTRIBUTION CENTRE  |
| 990       | H2 FUEL CELLS (FUTURE)   |

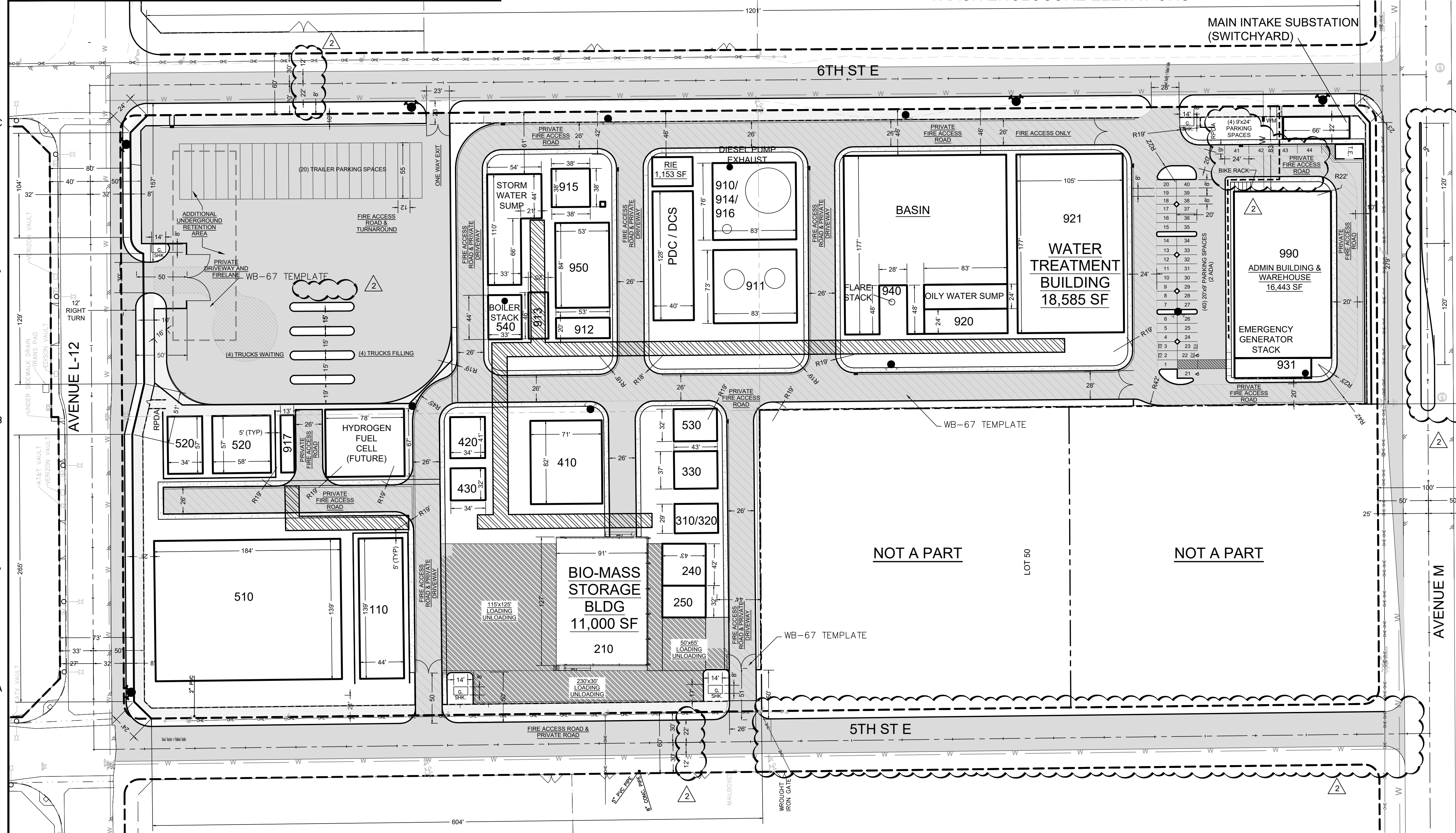

NEW OFF-SITE HYDRANT  
EX. PUBLIC HYDRANT

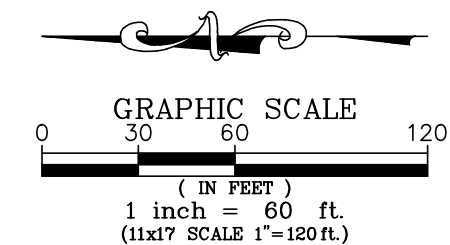

ENGINEER OF RECORD

**Duke Engineering**  
CIVIL & STRUCTURAL  
LANCASTER - CALIFORNIA

44732 YUCCA AVENUE  
LANCASTER, CA  
661-952-7918

| Revisions |                                     | No. | Revisions | By | Date     |
|-----------|-------------------------------------|-----|-----------|----|----------|
| 1         | PLANNING – 3RD PLAN CHECK REVISIONS |     |           | MM | 11/20/22 |
| 2         | PLANNING – 4TH PLAN CHECK REVISIONS |     |           | MM | 1/20/22  |
|           |                                     |     |           |    |          |
|           |                                     |     |           |    |          |
|           |                                     |     |           |    |          |
|           |                                     |     |           |    |          |

SHEET

SP1.00

Project No. 22075